

STRAIGHT BULKHEAD JACK SOLDER TYPE

R123.305.023

PANEL SEAL CABLE .141

Series : QMA

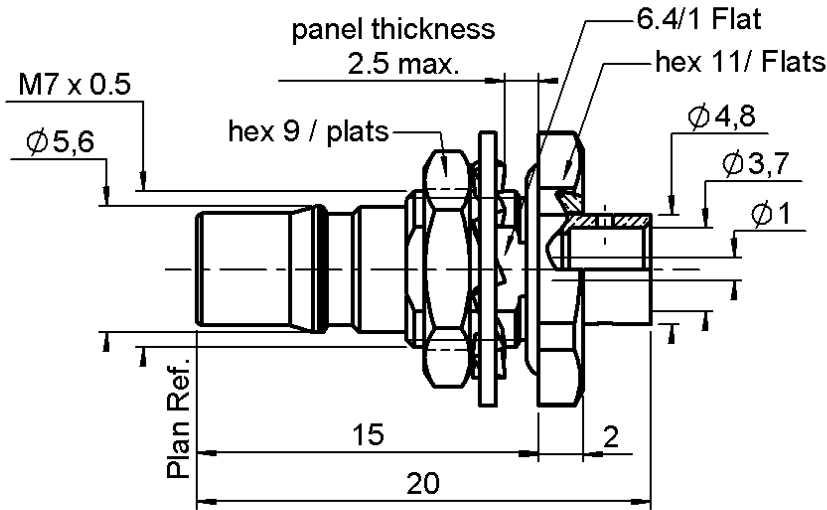

PANEL CUT OUT

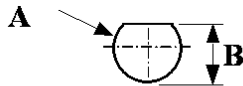

| | mm | |
|----------|------|------|
| | Maxi | mini |
| A | 7.3 | 7.2 |
| B | 6.65 | 6.5 |

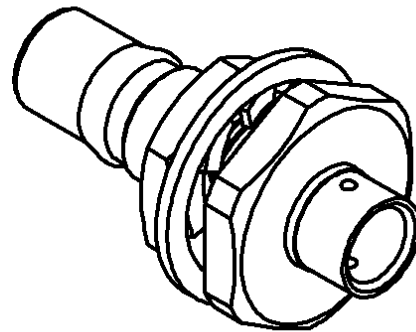
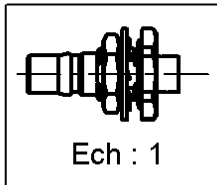

All dimensions are in mm.

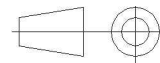

| COMPONENTS | MATERIALS | PLATINGS (µm) |
|----------------|------------------|--------------------------|
| BODY | BRASS | GOLD 0.8 OVER COPPER 0.5 |
| CENTER CONTACT | BERYLLIUM COPPER | GOLD 1.3 OVER COPPER 2.5 |
| OUTER CONTACT | | |
| INSULATOR | PTFE | |
| GASKET | SILICONE RUBBER | |
| OTHERS PARTS | - | - |
| - | - | - |
| - | - | - |

Issue : 0419 B

In the effort to improve our products, we reserve the right to make changes judged to be necessary.



STRAIGHT BULKHEAD JACK SOLDER TYPE

R123.305.023

PANEL SEAL CABLE .141

Series : QMA

PACKAGING

| Standard | Unit | Other |
|------------|-------------------|-------------------|
| 100 | 'W' option | Contact us |

SPECIFICATION

700-25242-0001

ELECTRICAL CHARACTERISTICS

| | | |
|---------------------------------|---------------|--------------------------------|
| Impedance | | 50 Ω |
| Frequency | | 0-6 GHz |
| VSWR | 1.15 + | 0.015 x F(GHz) Maxi |
| Insertion loss | | 0.05 √F(GHz) dB Maxi |
| RF leakage | - (| ***80 - F(GHz)) dB Maxi |
| Voltage rating | | 335 Veff Maxi |
| Dielectric withstanding voltage | | 1000 Veff mini |
| Insulation resistance | | 5000 MΩ mini |

CABLE ASSEMBLY

| Stripping | a | b | c | d | e | f |
|-----------|------|------|------|------|------|------|
| mm | 4.50 | 0.00 | 0.00 | 0.00 | 0.00 | 0.00 |

Assembly instruction :

Recommended cable(s)
 RG 402
 KS 2
 BELN 1673A
 HC80000-3
 BELN YQ43858

Characteristics indicated on this data sheet are those that can be achieved with the highest performance cable. Intrinsic limitations of the cable may diminish the performance of the assembly

Cable retention

| | |
|------------|-------------------|
| - pull off | 270 N mini |
| - torque | NA N.cm |

MECHANICAL CHARACTERISTICS

| | | |
|----------------------------|-----------|-----------|
| Center contact retention | | |
| Axial force – Mating end | NA | N mini |
| Axial force – Opposite end | NA | N mini |
| Torque | NA | N.cm mini |

TOOLING

| Part Number | Description | Hexagon |
|--------------|---------------------------------------|---------|
| . | . | . |
| R282.053.000 | STRIPPING TOOL | |
| R282.066.010 | | |
| R282.740.000 | SOLDERING MOUNTING | |
| R282.744.220 | SOLDERING POSITIONER (CENTER CONTACT) | |

| | | |
|--------------------|--------------|------|
| Recommended torque | | |
| Mating | NA | N.cm |
| Panel nut | 160 | N.cm |
| Clamp nut | NA | N.cm |
| A/F clamp nut | 0.000 | mm |

| | | |
|-------------|--------------|-------------|
| Mating life | 100 | Cycles mini |
| Weight | 4.450 | g |

ENVIRONMENTAL

| | | |
|-----------------------|----------------|-----------|
| Operating temperature | -40/+80 | ° C |
| Hermetic seal | NA | Atm.cm3/s |
| Panel leakage | IP67 | |

OTHERS CHARACTERISTICS

**Intermod.: -120dBc at 1.8GHz (2x20w)

***RF Leakage interf.only: 3<F<6GHz:>70dB

Issue : 0419 B

In the effort to improve our products, we reserve the right to make changes judged to be necessary.



STRAIGHT BULKHEAD JACK SOLDER TYPE

PANEL SEAL CABLE .141

R123.305.023

Series : QMA

COMPONENTS

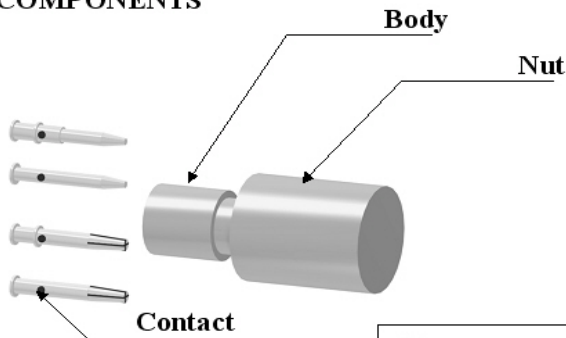

STRIPPING DIMENSIONS

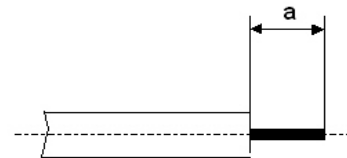

We recommend a thermal preconditionning cable

1

Insert the cable into the clamp element.
Present the pointer in front of the clamp element.
Push the cable until it stops, while holding the clamp element pushed on the hollow part of the pointer.
Turn the clamp element until the release of the pointer.

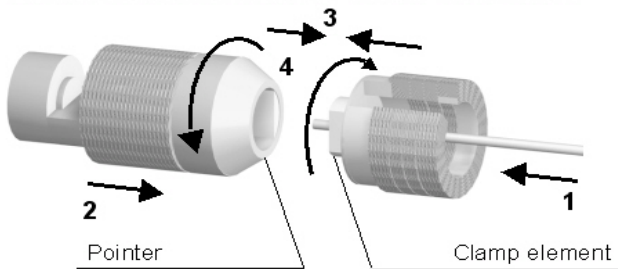

3

Mount the positioner A.
Slide the centre contact into the positioner A.
Insert the solder gauge (1 mm) between the centre contact and the cable.
Tighten
Solder the contact.

1 - Positioner A

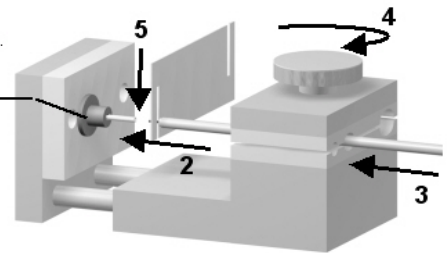

2

Present the cutting element in front of the clamp element.
Push and turn both elements , back part opposite to the front part. Once they reach the stop, pull without revolving.

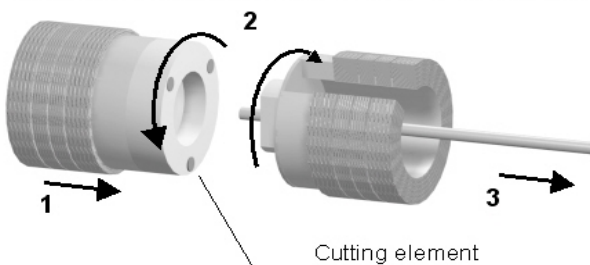

4

After cooling, remove the assembly from the jig.
Positioning the connector onto the Assembly jig.
Slide the cable into the connector until it bottoms against the insulator
Tighten.
Put three rings of solder around The able and solder.
After cooling, remove the assembly From the jig.

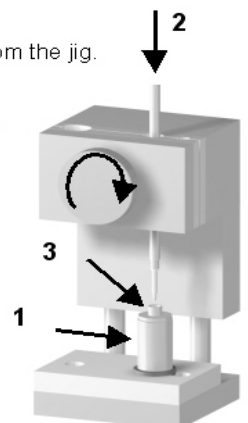

Issue : 0419 B

In the effort to improve our products, we reserve the right to make changes judged to be necessary.



RADIALL®